

STATE ENGINEER
Salem, Oregon

3516
MARI....16

Well Record

STATE WELL NO. 6/1W-31H(1).
COUNTY Marion
APPLICATION NO. GR-1088

GR- 1049

OWNER: Charles W. Kniess

MAILING ADDRESS: Rt. 2, Box 181

LOCATION OF WELL: Owner's No.

CITY AND STATE: Silverton, Oregon

SE 1/4 NE 1/4 Sec. 31 T. 6 S., R. 1 W., W.M.

Bearing and distance from section or subdivision

corner 67 ch. E. & 33 ch. S. from NW cor. Sec. 31

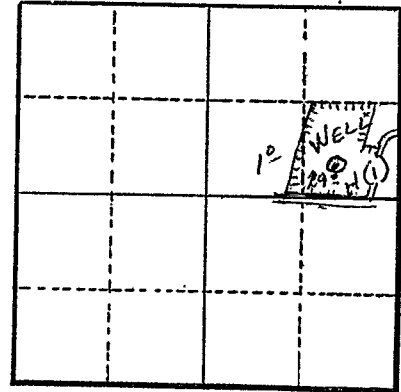

Section 31

Altitude at well 198 ft.

TYPE OF WELL: Drilled Date Constructed 1952

Depth drilled 169 ft. Depth cased 169 ft.

CASING RECORD:

12 inch

FINISH:

Mill knife slot perforations:	5/16 x 1 1/4 in. - two runs (approx. 40 holes)	93' to 161'
" "	" " " " " "	138' to 146'
" "	one run " 20 "	152' to 160'

AQUIFERS:

WATER LEVEL:

32 ft.

PUMPING EQUIPMENT: Type Peerless 4 in. turbine H.P. 10
Capacity 350 G.P.M.

WELL TESTS:

Drawdown	96 ft. after	hours	500	G.P.M.
Drawdown	59 ft. after	hours	200	G.P.M.

USE OF WATER Irrigation Temp. °F. 19

SOURCE OF INFORMATION R. G. Record

DRILLER or DIGGER Harris

ADDITIONAL DATA:

Log Water Level Measurements Chemical Analysis Aquifer Test

REMARKS:

Irrigation of 30 acres.

