

MORR  
1778

RECEIVED

02N | 26E | 06BA

OCT 30 1995

(START CARD) #

63421

STATE OF OREGON  
WATER WELL REPORT  
(as required by ORS 537.765)

Instructions for completing this report are on the last page of this form.

WATER RESOURCES DEPT.

(1) OWNER: Well Number \_\_\_\_\_

Name Cascade Speciaties  
Address OME Cascade Way  
City Boardman State OR Zip 97818

(2) TYPE OF WORK  
 New Well  Deepening  Alteration (repair/recondition)  Abandonment

(3) DRILL METHOD:  
 Rotary Air  Rotary Mud  Cable  Auger  
 Other \_\_\_\_\_

(4) PROPOSED USE:  
 Domestic  Community  Industrial  Irrigation  
 Thermal  Injection  Livestock  Other \_\_\_\_\_

(5) BORE HOLE CONSTRUCTION:  
Special Construction approval  Yes  No Depth of Completed Well 402 ft.  
Explosives used  Yes  No Type \_\_\_\_\_ Amount \_\_\_\_\_

HOLE			SEAL			Sacks or pounds
Diameter	From	To	Material	From	To	
16	0	172	Cement	172	50	84 lbs
	0	50	Bentonite			70 SKS
10	172	402				

How was seal placed: Method  A  B  C  D  E  
 Other Bentonite dry  
Backfill placed from \_\_\_\_\_ ft. to \_\_\_\_\_ ft. Material \_\_\_\_\_  
Gravel placed from \_\_\_\_\_ ft. to \_\_\_\_\_ ft. Size of gravel \_\_\_\_\_

(6) CASING/LINER:

Diameter	From	To	Gauge	Steel	Plastic	Welded	Threaded
Casing: 10	11	172	250	<input checked="" type="checkbox"/>	<input type="checkbox"/>	<input checked="" type="checkbox"/>	<input type="checkbox"/>
Liner:				<input type="checkbox"/>	<input type="checkbox"/>	<input type="checkbox"/>	<input type="checkbox"/>

Final location of shoe(s) 172

(7) PERFORATIONS/SCREENS:

From	To	Slot size	Number	Diameter	Tele/pipe size	Casing	Liner
						<input type="checkbox"/>	<input type="checkbox"/>
						<input type="checkbox"/>	<input type="checkbox"/>
						<input type="checkbox"/>	<input type="checkbox"/>
						<input type="checkbox"/>	<input type="checkbox"/>

(8) WELL TESTS: Minimum testing time is 1 hour  
 Pump  Bailer  Air  Flowing Artesian  
Yield gal/min 300+ Drawdown \_\_\_\_\_ Drill stem at 402 Time 1 hr.

Temperature of water 68 Depth Artesian Flow Found \_\_\_\_\_  
Was a water analysis done?  Yes By whom \_\_\_\_\_  
Did any strata contain water not suitable for intended use?  Too little  
 Salty  Muddy  Odor  Colored  Other \_\_\_\_\_  
Depth of strata: \_\_\_\_\_

SALEM, OREGON  
(9) LOCATION OF WELL by legal description:  
County Morrow Latitude \_\_\_\_\_ Longitude \_\_\_\_\_  
Township 2 N or S Range 26 E or W. WM.  
Section 6 NE 1/4 NW 1/4  
Tax Lot \_\_\_\_\_ Lot \_\_\_\_\_ Block \_\_\_\_\_ Subdivision \_\_\_\_\_  
Street Address of Well (or nearest address) SAME

(10) STATIC WATER LEVEL:  
230 ft. below land surface. Date 9-25-95  
Artesian pressure \_\_\_\_\_ lb. per square inch. Date \_\_\_\_\_

(11) WATER BEARING ZONES:

Depth at which water was first found 374

From	To	Estimated Flow Rate	SWL
374	398	300	230

(12) WELL LOG:  
Ground Elevation \_\_\_\_\_

Material	From	To	SWL
Silt	0	24	
Cemented gravels	24	58	
Tan Clay	58	94	
Red sandstone	94	120	
Brown Clay	120	141	
Brown Basalt	141	154	
Tan Clay	154	163	
Black Bolt	163	216	
Ala Breccia	216	220	
visicular / Blue Clay	220	231	
Black Basalt	231	237	
Red Cinders	237	241	
Black Basalt	241	320	
Green Basalt	320	374	
visicular Basalt	374	398	
Fractured Black Basalt	398	402	

Date started 8-28-95 Completed 9-25-95

(unbonded) Water Well Constructor Certification:  
I certify that the work I performed on the construction, alteration, or abandonment of this well is in compliance with Oregon water supply well construction standards. Materials used and information reported above are true to the best of my knowledge and belief.  
WWC Number \_\_\_\_\_  
Signed \_\_\_\_\_ Date \_\_\_\_\_

(bonded) Water Well Constructor Certification:  
I accept responsibility for the construction, alteration, or abandonment work performed on this well during the construction dates reported above. All work performed during this time is in compliance with Oregon water supply well construction standards. This report is true to the best of my knowledge and belief.  
WWC Number 759  
Signed [Signature] Date 9-26-95

# T. 2N. & 3N., R. 26E., W.M.

MORROW COUNTY

SCALE 1" = 1320'

**RECEIVED**

OCT 30 1995

WATER RESOURCES DEPT.  
SALEM, OREGON

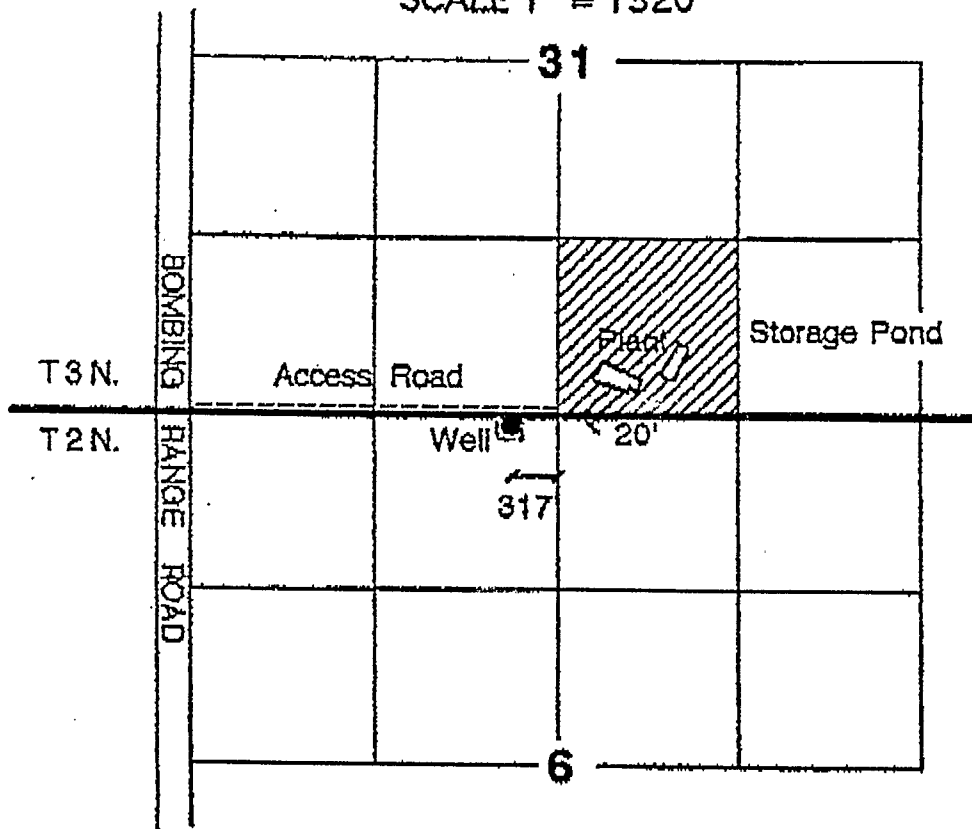

*Cascade  
Specialties  
NW 1/4  
Sec 6  
T2N 26E*

*ONE Cascade Way  
Boardman, OR  
97817*

Well Located 20' South & 317' West of the South Quarter Corner Section 31, T3N,R26E

## WATER TRANSFER APPLICATION MAP

 Water Use Transferred To This Location

IN NAME OF

*Larry Lindsey*

THIS MAP IS FOR THE PURPOSE  
OF IDENTIFYING THE LOCATION  
OF WATER RIGHTS ONLY AND IS  
NOT INTENDED TO PROVIDE THE  
LEGAL DIMENSIONS OR LOCATIONS  
OF PROPERTY OWNERSHIP LINES.

ENGINEERING - SURVEYING - WATER RIGHTS  
**R V MCKINNIS ENGINEERING**  
 Rt 1 Box 1122 Hermiston, Oregon 97838  
 503-567-2017