

The original and first copy of this report are to be filed with the

RECEIVED MAR 22 1971 STATE ENGINEER SALEM OREGON

STATE ENGINEER, SALEM, OREGON 97310 within 30 days from the date of well completion.

STATE OF OREGON (Please type or print) (Do not write above this line)

State Well No. MORR 545 2N/26-23

State Permit No. #62

G-5096 Well No. 1

(1) OWNER:

Name L.D., Corrine, & Rosella Lindsay Address Lindsay Ranch, Lexington, Ore. 97835

(2) TYPE OF WORK (check):

New Well [x] Deepening [ ] Reconditioning [ ] Abandon [ ] If abandonment, describe material and procedure in Item 12.

(3) TYPE OF WELL:

Rotary [ ] Driven [ ] Cable [x] Jetted [ ] Dug [ ] Bored [ ]

(4) PROPOSED USE (check):

Domestic [ ] Industrial [ ] Municipal [ ] Irrigation [x] Test Well [ ] Other [ ]

CASING INSTALLED:

16" Diam. from 0 ft. to 188'2" ft. Gage 250 12" Diam. from 509 ft. to 610 ft. Gage 20' 312 10" Diam. from 880 ft. to 1,130 ft. Gage 250

PERFORATIONS:

Perforated? [ ] Yes [x] No.

Type of perforator used

Table with columns: Size of perforations, in. by, in., perforations from, ft. to

(7) SCREENS:

Well screen installed? [ ] Yes [x] No

Manufacturer's Name Type Model No. Diam. Slot size Set from ft. to

(8) WATER LEVEL: Completed well.

Static level 223 ft. below land surface Date 2/20/71 Artesian pressure lbs. per square inch Date

(9) WELL TESTS:

Drawdown is amount water level is lowered below static level

Was a pump test made? [x] Yes [ ] No If yes, by whom? Layne Yield: 3,260 gal./min. with 34 ft. drawdown after 8 hrs. Bailer test NO gal./min. with ft. drawdown after hrs. Artesian flow g.p.m. Date Temperature of water 76 Was a chemical analysis made? [ ] Yes [x] No

(10) CONSTRUCTION:

Well seal—Material used Cement Depth of seal 31 ft. Diameter of well bore to bottom of seal 20 in. Were any loose strata cemented off? [ ] Yes [x] No Depth Was a drive shoe used? [x] Yes [ ] No Did any strata contain unusable water? [ ] Yes [x] No Type of water? depth of strata Method of sealing strata off Was well gravel packed? [ ] Yes [x] No Size of gravel: Gravel placed from ft. to ft.

(11) LOCATION OF WELL:

Sand Ranch Well County Morrow Driller's well number No. 1 NE 1/4 SW 1/4 Section 23 T. 2N R. 26 E. W.M.

Bearing and distance from section or subdivision corner 1,720.0 ft. east and 1,562.1 ft. north of S.W. corner of Sec. 23, T.2N., R. 26 E.W.M.

(12) WELL LOG:

Diameter of well below casing 10"

Depth drilled 1,145 ft. Depth of completed well 1,145 ft.

Formation: Describe color, texture, grain size and structure of materials; and show thickness and nature of each stratum and aquifer penetrated, with at least one entry for each change of formation. Report each change in position of Static Water Level as drilling proceeds. Note drilling rates.

Table with columns: MATERIAL, From, To, SWL. Rows include Sandy loam, Small Gravel, Cement Gravel, Brown Sand & Small Boulders, Blue Clay & Med. Gravel, Broken Blue Basalt, Blue Basalt, Gray Basalt (Hard), Soft Reddish-Brown Basalt, Blue Basalt, Blue Basalt (Soft), Gray Basalt Med. Hard, Gray Basalt Hard, Blue Basalt, Blue Basalt, Gray Basalt Hard, Broken Hard Gray Basalt, Soft Gray Rock, Blue Basalt, Blue Basalt Soft, Gray Basalt, Blue Black Basalt.

Work started 3/31/70 19 Completed 20 Feb. 1971

Date well drilling machine moved off of well 22 Feb. 1971

Drilling Machine Operator's Certification:

This well was constructed under my direct supervision. Materials used and information reported above are true to my best knowledge and belief.

[Signed] Thomas R. Ruther Date 19 Mar., 1971 (Drilling Machine Operator)

Drilling Machine Operator's License No. 138

Water Well Contractor's Certification:

This well was drilled under my jurisdiction and this report is true to the best of my knowledge and belief.

NAME Thomas R. Ruther (Person, firm or corporation) (Type or print)

Address 1421 Circle Dr., Walla Walla, Wash. 99362

[Signed] Thomas R. Ruther (Water Well Contractor)

Contractor's License No. 374 Date 19 Mar., 1971





WELL TESTING REPORT

Sand Ranch Well #1

Larry Lindsay

LOCATION

well No. 2

WELL 16 WELL DEPTH 1145 WATER TEMP. 76 STATIC WATER LEVEL 217  
 PIPE SIZE 10 DISCHARGE PIPE 12 COLUMN & LENGTH 490 AIRLINE 483  
 10" column with 14" string bowl

TIME	WATER LEVEL FT. FROM TOP	R. P. M.	ORIFICE READING	G. P. M.	REMARKS: SAND? CASCADING WATER? etc.
5:10	212 ft?	-	-	700	dirty water
5:15	220	up	7"	1300	"
5:35	220	same	7"	1300	starting to clear
5:45	220	up	18"	2089	" " 76 Temp
5:45	220	same	18"	2089	" " clearing
6:48	230	up	25"	2461	" "
7:22	230	same	25"	2461	" " (cleaning)
7:24	248	up	37"	3002	" " 76 Temp
8:20	248	same	37"	3002	(water clear)
8:30	257	1900	44"	3263	water dirty (20 minutes cleaner)
9:05	257	1900	44"	3263	water clear
9:35	257	1900	44"	3263	water clear
10:00	257	1900	44"	3263	"
10:30	257	1900	44"	3263	"
11:13	257	1900	44"	3000	"
11:14	253	1800	37"	3002	"
11:30	253	1800	37"	3102	"
11:31	234	1600	25"	2461	"
11:00	234	1600	25"	2461	"

RECOVERY TIME: FT. 1 MINUTE FT. 2 MINUTES FT. 3 MINUTES

APPROVED BY: *J. Mason* (LAYNE PUMPS, INC.) *Lindsay Ranch* by *L. D. Lindsay* (OWNER OF WELL)

INSTALLED BY: *Jimmie Beach* DATE: 2-16-71

Feet to Water

Field with  
450 ft 10" column  
5 days 14" bowl

Static Level 217  
Water Temp 36.0

Very busy  
Will No. 2  
Sand Round Well # 1

See 23 well

by J. D. Moore

117 feet below this point

U.S. G.S. Wells  
N.M.

1000  
1500  
2000  
2500  
3000  
3500  
4000

100  
200  
300  
400  
500

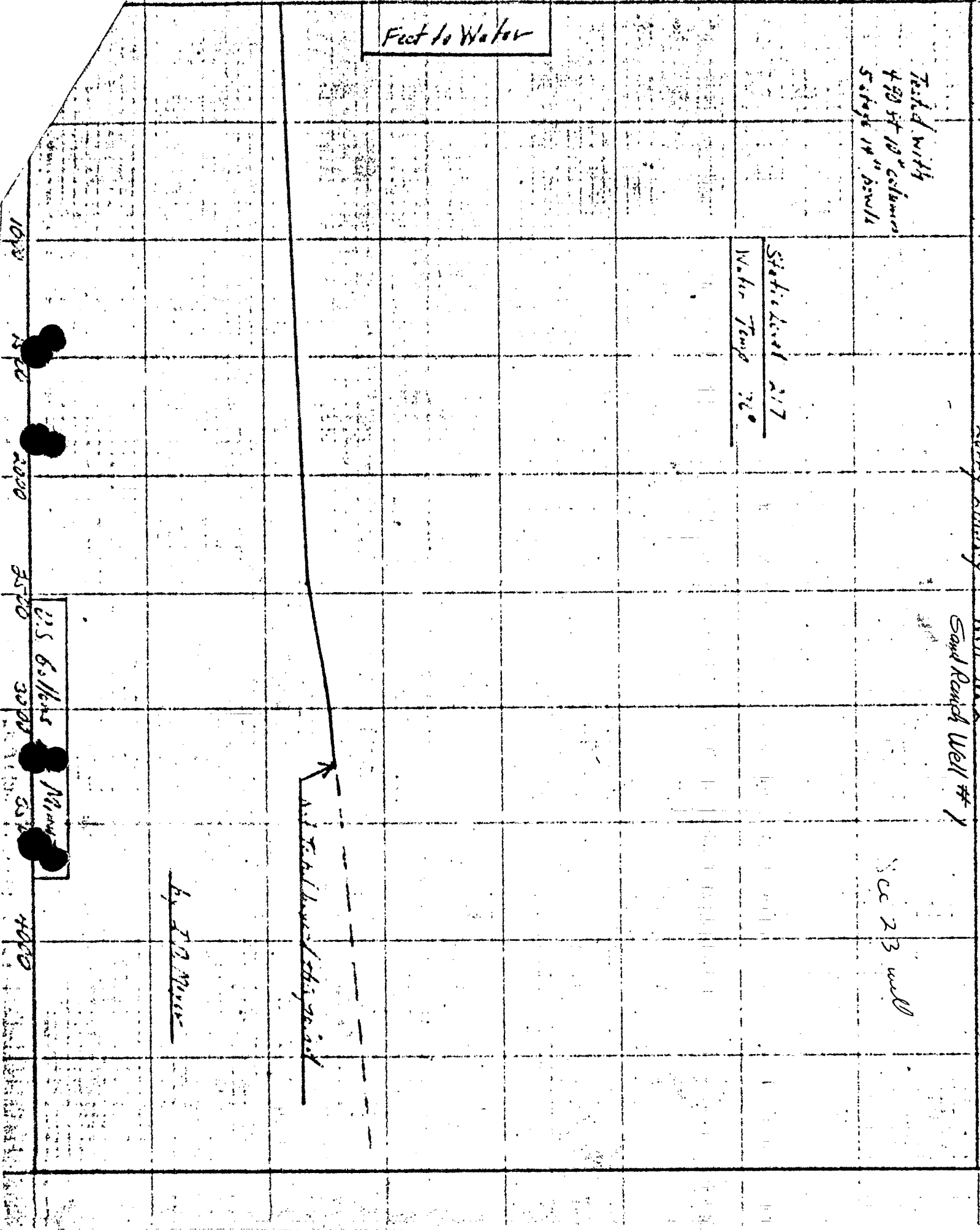

Log Book File  
DAVE

**RECEIVED**  
MAR 8 1971  
STATE ENGINEER  
SALEM OREGON

2/26-23  
~~Will Co.~~  
monow  
Lexington, Oregon  
Feb. 26, 1971

Mr. Wm. S. Bartholomew, Geologist  
State Engineer's Office, Salem, Oregon

Ret: Your letter of Feb. 12, 1971 re: Applic. No. G-5096

Dear Mr. Bartholomew,

I am sorry for the delay in answering your letter. We recently completed the first two wells of our "Sand Ranch Project" (Applic. No. G-5096). The pump tests were surprisingly good, the drawdown was slight, and the recovery rate immediate. The well logs and the pump test results should be in your office within the next few days.

Completed Wells:

Well #1: NE 1/4 SW 1/4, Sec. 23, T. 2 N, R. 26 E.

3,260 gpm from 257 ft.; 1,145 ft. in depth

Driller: Thomas R. Ruther

1421 Circle Drive, Walla Walla, Wash. 99362

Well #2: SE 1/4 SW 1/4, Sec. 10, T. 2 N, R. 26 E.

3,298 gpm from 262 ft.; 1,104 ft. in depth

Driller: Paul Wachter, Rte. 1, Box 133 F5, Pendleton

(Operator of Lindsay Ranch-owned well drill)

Wells in progress:

Well #3: SW 1/4 NW 1/4, Sec. 3, T. 2 N, R. 26 E.

Driller: D. K. Smith, P.O. Box 179, Walla Walla, Wash.

Well #4: SE 1/4 SW 1/4, Sec. 11, T. 2 N, R. 26 E.

Driller: Paul Wachter, Rte. 1, Box 133 F5, Pendleton

The well locations are identified on the revised map submitted to your office. We are happy to cooperate with your geologic studies in every way. If you have further questions, please let us know.

Yours truly,

L. D. Lindsay

Lindsay Ranch  
Lexington, Oreg.  
989-3468