

NOTICE TO WATER WELL CONTRACTOR
The original and first copy
of this report are to be
filed with the

WATER WELL REPORT

RECEIVED

STATE ENGINEER, SALEM, OREGON 97310
within 30 days from the date
of well completion.

STATE OF OREGON
(Please type or print)

JUL 8 1974

State Well No. 4N/25E-11aa

(Do not write above this line)

STATE ENGINEER
SALEM, OREGON

State Permit No.

MORR 769

(1) OWNER:

Name Howard Stone
Address P.O. Box 1097
Walla, Walla, Wash. 99362

(2) TYPE OF WORK (check):

New Well Deepening Reconditioning Abandon

If abandonment, describe material and procedure in Item 12.

(3) TYPE OF WELL:

(4) PROPOSED USE (check):

Rotary Driven
Cable Jetted
Dug Bored

Domestic Industrial Municipal
Irrigation Test Well Other

(10) LOCATION OF WELL:

County Morrow Driller's well number 63
NE ¼ NE ¼ Section 11 T. 4N R. 25E W.M.

Bearing and distance from section or subdivision corner

450' NE. of SW Corner of NE ¼
of NE ¼ of sec. 11

(11) WATER LEVEL: Completed well.

Depth at which water was first found 50.0 ft.

Static level 45.0 ft. below land surface. Date 6-10-74

Artesian pressure NONE lbs. per square inch. Date 6-10-74

(12) WELL LOG: Diameter of well below casing 20."

Depth drilled 71.0 ft. Depth of completed well 71.0 ft.

Formation: Describe color, texture, grain size and structure of materials; and show thickness and nature of each stratum and aquifer penetrated, with at least one entry for each change of formation. Report each change in position of Static Water Level and indicate principal water-bearing strata.

MATERIAL	From	To	SWL
Sandy silt	0.0	16.0	
silt & sand	16.0	31.0	
Grey sand	31.0	42.0	
Sand & coarse gravel	42.0	70.0	45.0
Basalt Rock	70.0	71.0	45.0

CASING INSTALLED:

Threaded Welded

0.0" Diam. from 0.0 ft. to 70.0 ft. Gage 375
" Diam. from " ft. to " ft. Gage
" Diam. from " ft. to " ft. Gage

PERFORATIONS:

Perforated? Yes No.

Type of perforator used Mills Knife
Size of perforations 1/2 in. by 3 in.
544 perforations from 50 ft. to 67 ft.
" perforations from " ft. to " ft.
" perforations from " ft. to " ft.

(7) SCREENS:

Well screen installed? Yes No

Manufacturer's Name _____
Type _____ Model No. _____
Diam. _____ Slot size _____ Set from _____ ft. to _____ ft.
Diam. _____ Slot size _____ Set from _____ ft. to _____ ft.

(8) WELL TESTS:

Drawdown is amount water level is lowered below static level

Was a pump test made? Yes No If yes, by whom?

Yield: _____ gal./min. with _____ ft. drawdown after _____ hrs.
" " " " " " "
" " " " " " "
Bailer test 100 gal./min. with 0 ft. drawdown after 1 1/2 hrs.
Artesian flow NONE g.p.m.

Temperature of water 54 Depth artesian flow encountered NONE ft.

(9) CONSTRUCTION:

Well seal—Material used Volclay Bentonite
Well sealed from land surface to 28 ft.
Diameter of well bore to bottom of seal 2.6 in.
Diameter of well bore below seal 2 1/2 in. Drive shoe
Number of sacks of cement used in well seal 0 sacks
Number of sacks of bentonite used in well seal 6 sacks
Brand name of bentonite Volclay
Number of pounds of bentonite per 100 gallons of water 75 lbs./100 gals.
Was a drive shoe used? Yes No Plugs _____ Size: location _____ ft.
Did any strata contain unusable water? Yes No
Type of water? _____ depth of strata _____
Method of sealing strata off _____
Was well gravel packed? Yes No Size of gravel: _____
Gravel placed from 0 ft. to 4 ft.

Work started May 22 19 74 Completed June 10 19 74
Date well drilling machine moved off of well June 10 19 74

Drilling Machine Operator's Certification:

This well was constructed under my direct supervision. Materials used and information reported above are true to my best knowledge and belief.

[Signed] James H Smith Date 7-3 19 74
(Drilling Machine Operator)

Drilling Machine Operator's License No. 963

Water Well Contractor's Certification:

This well was drilled under my jurisdiction and this report is true to the best of my knowledge and belief.

Name B & B Drilling Co. (Type or print)
(Person, firm or corporation)

Address P.O. Box 124 Hermiston, Ore. 97138

[Signed] John L. Brown (Water Well Contractor)

Contractor's License No. 516 Date July 3 19 74

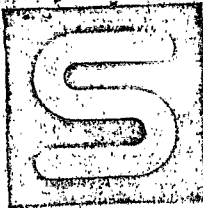

WALLA WALLA, WASHINGTON
 MILTON FREEWATER, OREGON
 PENDELTON, OREGON
 THE DALLES, OREGON

STONE MACHINERY CO.

CATERPILLAR TOWMOTOR MABBOY THOUSON

Arnold: as you can see
 this well is only 72' deep
 w/ 60' column and the gallons
 were good around 60'. It
 looks like a good one. We
 have about 4900^{gals} in it.
 Let me know if you need
 anymore information.

Howard Stone

Box 1097

Walla Walla, WASH

99362

Location: SE of ...

STATIC WATER LEVEL
 & LENGTH 60 AIRLINE 54

. M.	REMARKS:
	SAND? CASCADING WATER?
50	Hard & light ...
40	Light sand
30	...
21	...
88	...
41	...
78	...
41	...
28	...
10	...
20	...
10	...
10	...
10	...
10	...
10	...
10	...
10	...
10	...
10	...
10	...

RECOVERY TIME: 54 FT. 1 MINUTE 54 FT. 2 MINUTES 54 FT. 3 MINUTE

APPROVED BY: *Howard Stone*

Green Valley Pump Services, Inc
 INSTALLED BY: [Signature]
 Green Valley Pump Services, Inc
 Pasco, Washington

(OWNER OF WELL)
 DATE: July 1

GREEN VALLEY

PUMP INC.

*Send me Call
Salmon*

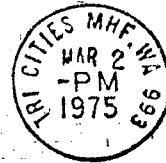

KENNEB
PAS
RICHL

1308 E. HILLSBORO

P. O. BOX 2821

PASCO, WA 99302

*Well testers
(test data on last sheet)*

Arnold Braat

Rt. #1

Box 74

1) Boardman, Ore. 9

Owner Stone Date 5-3-74
5-20-74
 Location Boardman 450' NE of SW corner of NE 1/4 NE 1/4
S 11, T 4 N, R 25 E
 City _____ State _____
 Total Depth 70'
 Static Water Level 50'
 Casing Size 20"
 Screen Size _____ Length _____
 Kind of Wire _____ Gauge _____
 Estimated Capacity _____ gals./min.
 Kind of Pump _____
 Depth of Pump Setting _____ Ft.
 H.P. _____ Voltage _____ Phase _____
 Size of Tank _____

Log of Well		Drill Pipe	Depth	Casing
Soil	300			Shoe
Sand & silt		Bit		1 25°
		1		2 9°
		2		3 10°
Gravel		3		4 10°
50	350	4		5 5°
50	50	5		6 5°
50	10	6	69'	7 5°
		7		8
		8		9
100	400	9		10
		10		11
		11		12
		12		13
		13		14
150	450	14		15
		15		16
		16		17
		17		18
		18		19
		19		20
200	500	20		21
		21		22
		22		23
		23		24
		24		25
250	550	25		26

*Perforated from 50° to 67°
 1/2 x 3, 16 per round, one
 round every six inches*

*After perforating SWL
 rose to 45°*

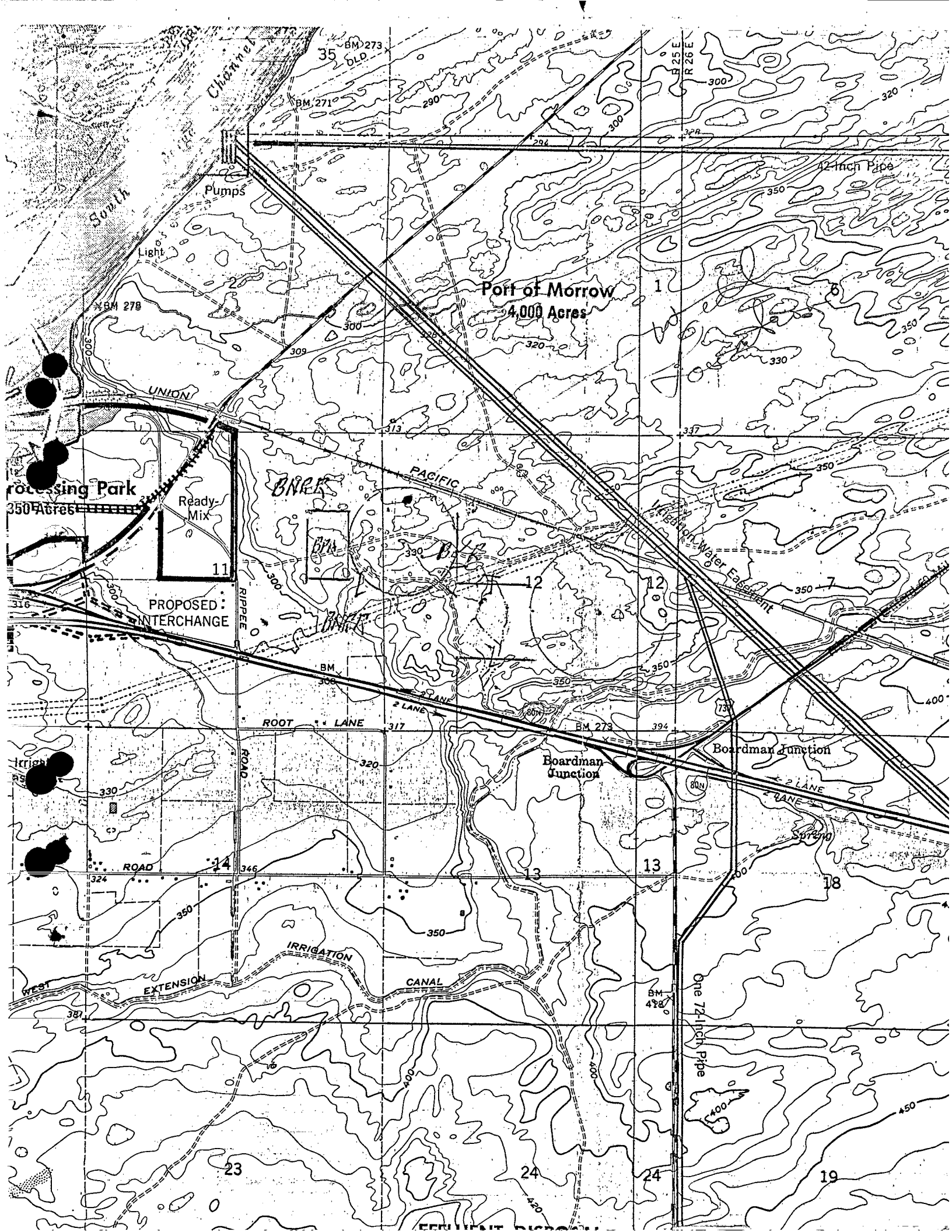

Port of Morrow
4,000 Acres

Processing Park
350 Acres

PROPOSED
INTERCHANGE

Ready-Mix

UNION
PACIFIC

Boardman
Junction

Boardman Junction

ROOT LANE

WEST EXTENSION

IRRIGATION
CANAL

One 72-inch Pipe

19

24

24

23

330

324

387

316

309

300

BM 308

BM 273

BM 308

BM 273

BM 271

BM 278

BM 498

300

309

313

330

317

320

350

400

420

350

350

350

350

300

400

400

400

350

350

450

328

328

337

350

350

350

350

350

350

350

350

328

328

337

350

350

350

350

350

350

350

350

328

328

337

350

350

350

350

350

350

350

350

B 25 E
B 26 E

B 25 E
B 26 E

B 25 E
B 26 E

B 25 E
B 26 E

B 25 E
B 26 E

B 25 E
B 26 E

B 25 E
B 26 E

B 25 E
B 26 E

B 25 E
B 26 E

B 25 E
B 26 E

B 25 E
B 26 E

B 25 E
B 26 E

South

Channel

Pumps

Light

42-inch Pipe

Water Equipment

Spillage

PERMIT DISCLOSED

4N/25E-12

NE NE

Howard Stone

ARNOLD
BRAAT Bought

these info you 4/30/75
EGG

WELL TESTING REPORT

Brampton, Saskatchewan

NAME *Howard Stone*

LOCATION *SE E of Brampton*

I. D. WELL *20*

WELL DEPTH *72*

WATER TEMP. _____

STATIC WATER LEVEL _____

ORIFICE SIZE _____

DISCHARGE PIPE *10*

COLUMN & LENGTH *60*

AIRLINE *8' 1/2*

Open Discharge

TIME	WATER LEVEL FT. FROM TOP	R. P. M.	ORIFICE READING	G. P. M.	REMARKS: SAND? CASCADING WATER?
<i>1:00</i>	<i>54</i>		<i>—</i>	<i>—</i>	<i>Sand & light foam</i>
<i>1:30</i>				<i>850</i>	<i>Discontinued</i>
<i>2:00</i>					<i>light sand</i>
<i>2:30</i>	<i>59</i>				<i>cleaning</i>
<i>3:00</i>			<i>12</i>	<i>980</i>	
<i>3:30</i>			<i>24</i>	<i>1961</i>	
<i>4:00</i>	<i>59</i>		<i>28</i>	<i>2788</i>	
<i>4:30</i>	<i>59</i>		<i>31</i>	<i>2541</i>	
<i>5:00</i>	<i>60</i>		<i>34</i>	<i>2778</i>	
<i>5:15</i>	<i>61 1/2</i>		<i>36</i>	<i>2941</i>	
<i>5:30</i>	<i>61</i>		<i>34</i>	<i>2778</i>	

RECOVERY TIME: *54* FT. 1 MINUTE *54* FT. 2 MINUTES *54* FT. 3 MINUTE

APPROVED BY: *Norm Sabates mgr*

Green Valley Pump Services, Inc

(OWNER OF WELL)

INSTALLED BY: _____

DATE *July 1*

Green Valley Pump Vertical Turbine Pump
Pasco, Washington

FACTORY BRANCH

Phone *347*