



STATE ENGINEER  
Salem, Oregon

MULT  
1042

# Well Record

STATE WELL NO. 1N/1 - 33R  
COUNTY Multnomah  
APPLICATION NO. GR-2005

OWNER: The Pacific Telephone & Telegraph Co. MAILING ADDRESS: 509 S.W. Oak St. Pg 2 of 5

LOCATION OF WELL: Owner's No. No. 2 CITY AND STATE: Portland 4, Oregon

SE ¼ SE ¼ Sec. 33 T. 1 N. S. R. 1 W. W.M.

Bearing and distance from section or subdivision corner 450' North & 1000' West from SE corner Section 33

Altitude at well \_\_\_\_\_

TYPE OF WELL: Drilled Date Constructed 1947

Depth drilled 255 Depth cased 255 Section \_\_\_\_\_

### CASING RECORD:

8-inch

### FINISH:

Perforations from 205 to 255

### AQUIFERS:

Gravel

### WATER LEVEL:

210 feet

PUMPING EQUIPMENT: Type Turbine H.P. 3  
Capacity 300 G.P.M.

### WELL TESTS:

Drawdown 200 ft. after \_\_\_\_\_ hours Pumping 299 G.P.M.

Drawdown \_\_\_\_\_ ft. after \_\_\_\_\_ hours \_\_\_\_\_ G.P.M.

USE OF WATER Cooling Temp. \_\_\_\_\_ °F. \_\_\_\_\_ 19

SOURCE OF INFORMATION GR-1880

DRILLER or DIGGER Janssen Drilling Company

### ADDITIONAL DATA:

Log  Water Level Measurements \_\_\_\_\_ Chemical Analysis \_\_\_\_\_ Aquifer Test \_\_\_\_\_

### REMARKS:

Gravel 0 to 210  
Water Bearing Gravel 210 to 255

THE PACIFIC TELEPHONE & TELEGRAPH CO.  
PORTLAND, OREGON

IN/1-33R3

P 3 of 5

mult  
1042

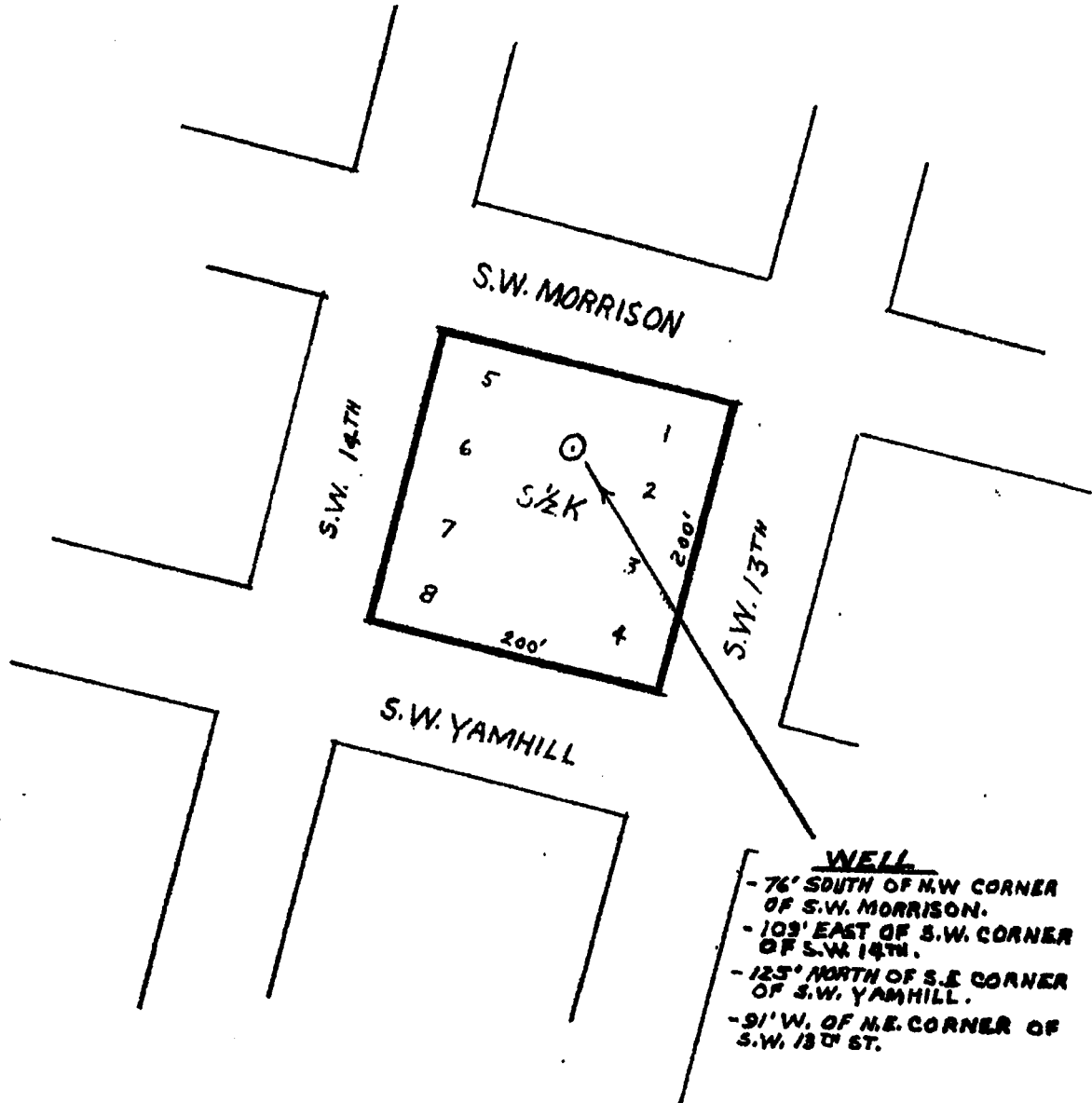

- WELL**
- 76' SOUTH OF N.W. CORNER OF S.W. MORRISON.
  - 103' EAST OF S.W. CORNER OF S.W. 14TH.
  - 125' NORTH OF S.E. CORNER OF S.W. YAMHILL.
  - 91' W. OF N.E. CORNER OF S.W. 13TH ST.

GR 2005

SITE PLAN  
PORTLAND ADDITION  
1334 S.W. MORRISON ST  
PORTLAND, OREGON

SCALE 1" = 100'

STATE ENGINEER  
Salem, Oregon

mult  
7042

State Well No. 1N/1-33R3

County Multnomah

Application No. \_\_\_\_\_

### Water Level Record

Pg 4 of 5

OWNER: Pacific Telephone & Telegraph Co. OWNER'S NO. \_\_\_\_\_

Description of measuring point: \_\_\_\_\_

Date	Water Level Feet (above) (below) Land Surface	Remarks	Date	Water Level Feet (above) (below) Land Surface	Remarks
2/21/61		(CANT measure) WSR			
6-1-61		" "			
7-18-61		" "			

REMARKS: \_\_\_\_\_

\_\_\_\_\_

\_\_\_\_\_

STATE ENGINEER  
Salem, Oregon

MUH  
7042

State Well No. 1N/1-33R3

County Multnomah

Application No. \_\_\_\_\_

### Water Level Record

Pg 5 of 5

OWNER: Pacific Telephone Co. OWNER'S NO. \_\_\_\_\_

Description of measuring point: \_\_\_\_\_

Electrical Conductivity in micromhos at 25°C

Date	Water Level Feet (above or below) Land Surface	Remarks	Date	Water Level Feet (above or below) Land Surface	Remarks
6-1-61	380	WSB Co.			
7-17-61	390	WSB Co.			
10-9-61	370	WSB Co.			

REMARKS: \_\_\_\_\_  
\_\_\_\_\_  
\_\_\_\_\_