

STATE ENGINEER
Salem, Oregon

MULT
001318

Well Record

GR- 1587

STATE WELL NO. 1N/3-23E
COUNTY Multnomah
APPLICATION NO. GR- 1444

OWNER: Fairview Farms Inc.

MAILING ADDRESS: Rt. 2, Box 40

LOCATION OF WELL: Owner's No. #4

CITY AND STATE: Troutdale, Oregon

SW 1/4 NW 1/4 Sec. 23 T. 1 N. S, R. 3 E. W., W.M.

Bearing and distance from section or subdivision corner For location see sketch on map

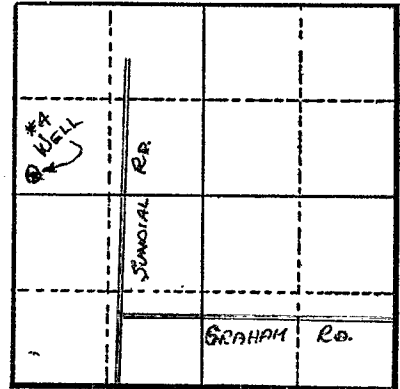

Section 23

Altitude at well 26'

TYPE OF WELL: Drilled Date Constructed 1943

Depth drilled 281' Depth cased 281'

CASING RECORD:

- 24" from 0 to 55 ft.
- 12" from 55 to 230 ft.
- 8" from 209 to 281 ft.

FINISH:

8" casing perforated from 237 to 250 ft.

AQUIFERS:

WATER LEVEL:

11'

PUMPING EQUIPMENT: Type Pomona turbine H.P. 40
Capacity 700 G.P.M.

WELL TESTS:

Drawdown 28 ft. after hours 700 G.P.M.

Drawdown ft. after hours G.P.M.

USE OF WATER Dom., Irrigation & Manuf. Temp. °F. 19

SOURCE OF INFORMATION GR Record

DRILLER or DIGGER

ADDITIONAL DATA:

Log Water Level Measurements Chemical Analysis Aquifer Test

REMARKS:

- Log: Yellow clay 0 to 16 ft.
- Blue sand & silt 16 to 35 ft.
- Quick sand 35 to 56 ft.
- Dark coarse sand 56 to 108 ft.
- Gray sand 108 to 168 ft.
- Some gravel in sand (water) 168 to 182 ft.
- Gray sand 182 to 231 ft.
- Water bearing sand & gravel 231 to 250 ft.
- Cemented gravel 250 to 281 ft.

Irrigation of 178 acres.