

STATE ENGINEER  
Salem, Oregon

MULT Well Record  
001384

STATE WELL NO. 1N/3-28G  
COUNTY Multnomah  
APPLICATION NO. GR-1440

OWNER: Fairview Farms Inc. GR- 1586  
MAILING ADDRESS: Rt. 2, Box 40  
CITY AND STATE: Troutdale, Oregon

LOCATION OF WELL: Owner's No. #3  
SW 1/4 NE 1/4 Sec. 28 T. 1 N. 8, R. 3 E. W., W.M.

Bearing and distance from section or subdivision corner For location see sketch on map

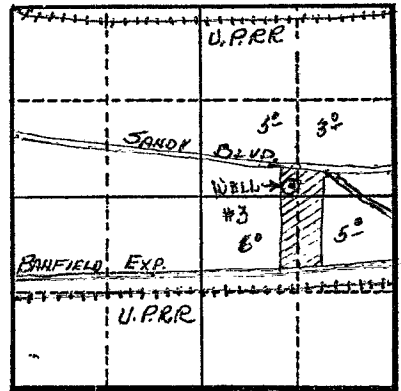

Section 28

Altitude at well 85'

TYPE OF WELL: Drilled Date Constructed 1954

Depth drilled 151' Depth cased 151'

CASING RECORD:  
8"

FINISH:  
10 rows of perforations from 139 to 149 ft.

AQUIFERS:

WATER LEVEL:  
68'

PUMPING EQUIPMENT: Type Peerless turbine H.P. 15  
Capacity 275 G.P.M.

WELL TESTS:  
Drawdown 9 ft. after 200 hours G.P.M.  
Drawdown 16 ft. after 300 hours G.P.M.

USE OF WATER Dom. & Irrigation Temp. °F., 19

SOURCE OF INFORMATION GR Record

DRILLER or DIGGER

ADDITIONAL DATA:  
Log Water Level Measurements Chemical Analysis Aquifer Test

REMARKS:  
Log: Clay & boulders 0 to 14 ft.  
Large cemented gravel 14 to 30 ft.  
Gravel with clay binder 30 to 52 ft.  
Cemented gravel & sand & gravel & clay 52 to 80 ft.  
Cemented gravel 80 to 139 ft.  
Loose gravel & sand (water) 139 to 151 ft.

Irrigation of 17 acres.