

STATE ENGINEER
Salem, Oregon

MULT
002182

Well Record

GR- 1733

STATE WELL NO. 1/3-14C
COUNTY Multnomah
APPLICATION NO. GR- 1791

OWNER: Melvin D. Gradin MAILING ADDRESS: Rt. 2, Box 917

LOCATION OF WELL: Owner's No. #1 CITY AND STATE: Gresham, Oregon

NE 1/4 NW 1/4 Sec. 14 T. 1 S., R. 3 XX, W.M.

Bearing and distance from section or subdivision corner 1100' S. & 1700' E. from NW cor. Sec. 14

Altitude at well 390'

TYPE OF WELL: Drilled Date Constructed 1936

Depth drilled 240' Depth cased 240'

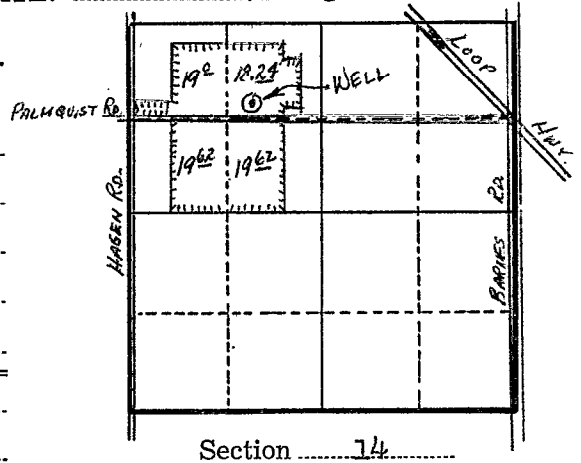

CASING RECORD:

8" from 0 to 212 ft.
6" from 212 to 140 ft.

FINISH:

8" pipe perforated from 106 to 185 ft.
6" pipe perforated from 212 to 240 ft.

AQUIFERS:

WATER LEVEL:

60'

PUMPING EQUIPMENT: Type Pomona turbine H.P. 5

Capacity 60 G.P.M.

WELL TESTS:

Drawdown 100 ft. after 60 hours 60 G.P.M.

Drawdown ft. after hours G.P.M.

USE OF WATER Irrigation Temp. °F. 19

SOURCE OF INFORMATION GR Record

DRILLER or DIGGER R. J. Strasser

ADDITIONAL DATA:

Log Water Level Measurements Chemical Analysis Aquifer Test

REMARKS:

Log: Cemented gravel all the way down.

Irrigation of 76.48 acres.