

STATE OF OREGON
GEOTECHNICAL HOLE REPORT
(as required by OAR 690-240-035)

MULT 53968

Received date

(1) OWNER/PROJECT

Hole No. 5
Co. Job No. 499
Name **OIL COMPANY CARSON**
CARSON OIL COMPANY
Street **3125 NW 35TH AVE**
City **PORTLAND** State **OR** Zip **97210**

(2) TYPE OF WORK

☒ New ☐ Alter (Recondition) ☐ Alter (Repair)
☐ Deepening ☐ Abandonment

(3) CONSTRUCTION

☐ Rotary Air ☐ Hand Auger ☐ Hollow Stem Auger
☐ Rotary Mud ☐ Cable Tool ☒ Push Probe Other

(4) TYPE OF HOLE

☒ Uncased Temporary ☐ Cased Permanent
☐ Uncased Permanent ☐ Slope Stabilit Other

(5) USE OF HOLE

(6) BORE HOLE CONSTRUCTION

Special Standards ☐ Depth of completed well 16 ft.

HOLE	Diameter		From		To	
	1.50		0		16	

SEAL	From		Material	Amount	Seal Grout Weight	Units
	0	16	BE	8		P

Backfill placed from ft. TO ft. Material
Filter pack placed from ft. TO ft. Size in.

(7) CASING/SCREEN

Screen ☐

(8) WELL TEST

Permeability Yield GPM
Conductivity PH
Temperature of water °F/C Depth artesian flow found ft.
Was water analysis done? ☐
By Whom? **WOHLERS ENVIRONMENTAL**
Depth of strata to be analyzed. From ft. to ft.
Remarks
Name of supervising Geologist/Engineer

(9) LOCATION OF HOLE By legal description

County **Multnomah** Latitude Longitude
Township **1.00 N** Range **1.00 E**
Section **24** **NW 1/4 NW 1/4**
Tax lot Lot Block Subdivision
Legal desc:

Street Address of Well (or nearest address)
3125 NW 35TH AVE

MAP with location identified must be attached

(10) STATIC WATER LEVEL

Ft. below land surface. Date
Artesian Pressure lb/sq. in. Date

(11) SUBSURFACE LOG

Ground Elevation ft.

Material	From	To	SWL
SANDS	0	16	

Date started **7/1/1997** Completed **7/1/1997**

(12) ABANDONMENT LOG

Date started Completed

Professional Certification

(to be signed by a licensed water supply or monitoring well constructor, or registered geologist or civil engineer).

I accept responsibility for the construction, alteration, or abandonment work performed on this well during the construction dates reported above. All work performed during this time is in compliance with Oregon geotechnical hole construction standards. This report is true to the best of my knowledge and belief.

License or Registration Number **10410**

Signed By **JEFF GINTER**

Date

Affiliation **GEO-TECH EXPLORATIONS**

Multnomah 53963-53964
53966-53971

North
↑

Date	Depth (feet/kg)	TPH-HCSD	TPH-418.1M (mg/kg)
6-11-97	2	Diesel	32

Date	Depth (feet/kg)	TPH-HCSD	TPH-418.1M (mg/kg)
6-11-97	1.75	Diesel	2,580
6-11-97	9	Diesel	965
6-11-97	11	Gasoline, diesel	20,600

4 = possible matrix interference

Date	Depth (feet/kg)	TPH-HCSD	TPH-418.1M (mg/kg)
6-11-97	2	Diesel	4,340

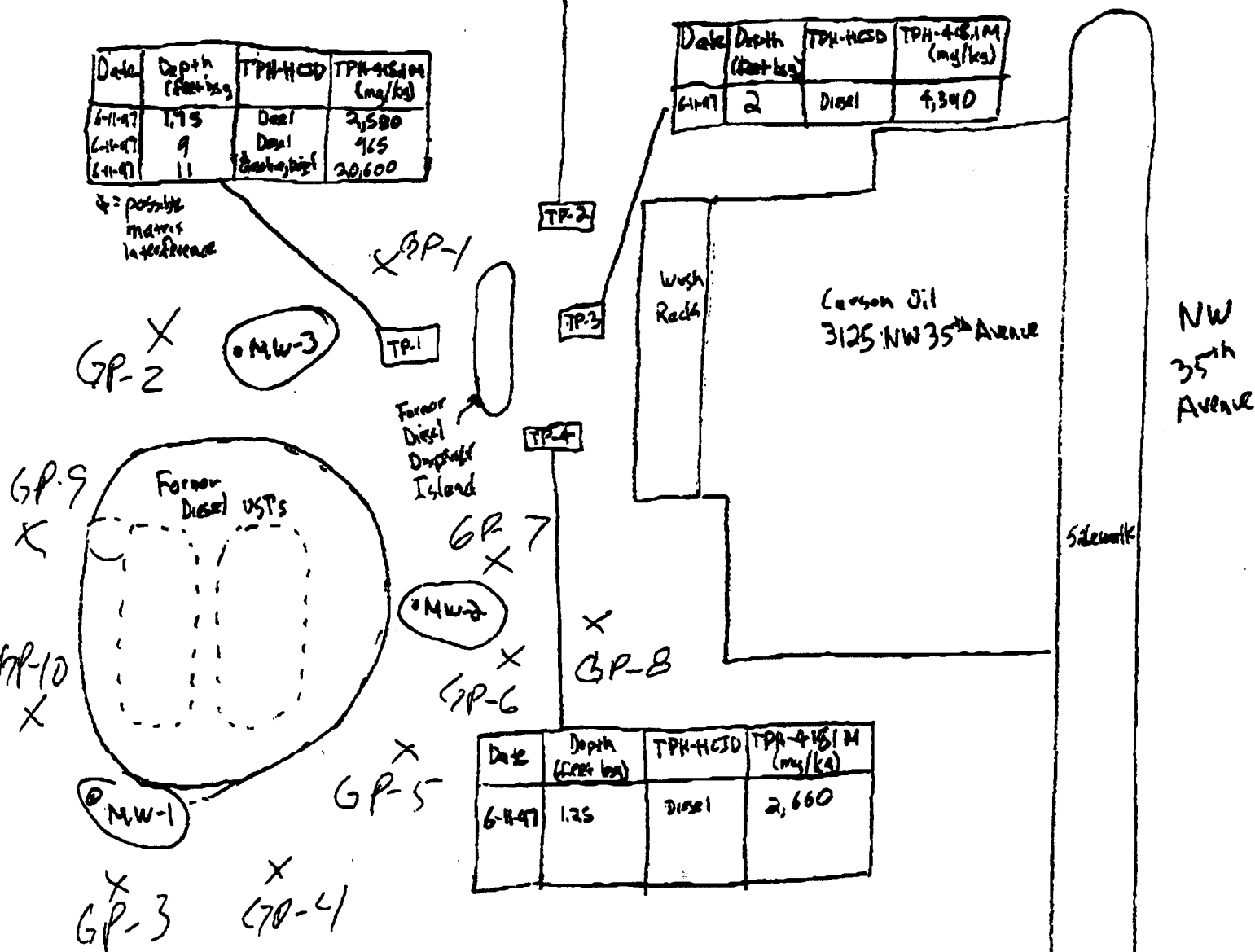

Date	Depth (feet/kg)	TPH-HCSD	TPH-418.1M (mg/kg)
6-11-97	1.25	Diesel	2,660

Test Pit Soil Sample
Analytical Results