

MULT 97681

MULT 97681

STATE OF OREGON
WATER SUPPLY WELL REPORT
(as required by ORS 537.765 & OAR 690-205-0210)

WELL LABEL # L 91674
START CARD # 1004850

(1) LAND OWNER Owner Well I.D. 2
First Name _____ Last Name _____
Company MCKINSTRY CO LLC
Address PO BOX 24567
City SEATTLE State WA Zip 98124

(2) TYPE OF WORK New Well Deepening Conversion
 Alteration (repair/recondition) Abandonment

(3) DRILL METHOD
 Rotary Air Rotary Mud Cable Auger Cable Mud
 Reverse Rotary Other _____

(4) PROPOSED USE Domestic Irrigation Community
 Industrial/ Commercial Livestock Dewatering
 Thermal Injection Other _____

(5) BORE HOLE CONSTRUCTION Special Standard (Attach copy)
Depth of Completed Well 120 ft.

BORE HOLE			SEAL			sacks/ lbs
Dia	From	To	Material	From	To	
16	0	120	Bentonite Chips	0	40	100

How was seal placed: Method A B C D E
 Other _____
Backfill placed from _____ ft. to _____ ft. Material _____
Filter pack from 40 ft. to 120 ft. Material Silica Sand Size 10/20
Explosives used: Yes Type _____ Amount _____

(6) CASING/LINER

Casing	Liner	Dia	+	From	To	Gauge	Stl	Plstc	Wld	Thrd
<input checked="" type="checkbox"/>	<input checked="" type="checkbox"/>	12		2	79.5	.365	<input checked="" type="checkbox"/>	<input type="checkbox"/>	<input checked="" type="checkbox"/>	<input type="checkbox"/>
<input type="checkbox"/>	<input type="checkbox"/>	12		115	120	.365	<input type="checkbox"/>	<input type="checkbox"/>	<input checked="" type="checkbox"/>	<input type="checkbox"/>
<input type="checkbox"/>	<input type="checkbox"/>						<input type="checkbox"/>	<input type="checkbox"/>	<input type="checkbox"/>	<input type="checkbox"/>

Shoe Inside Outside Other Location of shoe(s) _____
Temp casing Yes Dia _____ From _____ To _____

(7) PERFORATIONS/SCREENS
Perforations Method _____
Screens Type Wire Wrap Material Stainless

Perf/S creen	Casing/ Liner	Screen Dia	From	To	Scr/slot width	Slot length	# of slots	Tele/ pipe size
		12	79.5	115	.03			9.5

(8) WELL TESTS: Minimum testing time is 1 hour
 Pump Bailer Air Flowing Artesian
Yield gal/min 93 Drawdown 41 Drill stem/Pump depth 75 Duration (hr) 16

Temperature 52 °F Lab analysis Yes By _____
Water quality concerns? Yes (describe below)

From	To	Description	Amount	Units

(9) LOCATION OF WELL (legal description)
County MULTNOM Twp 1 N N/S Range 3 E E/W WM
Sec 19 NE 1/4 of the SW 1/4 Tax Lot 00311
Tax Map Number _____ Lot _____
Lat _____ ° _____ ' _____ " or _____ DMS or DD
Long _____ ° _____ ' _____ " or _____ DMS or DD
 Street address of well Nearest address
16790 NE MASON ST PORTLAND, OR 97230

(10) STATIC WATER LEVEL
Date 10-21-08 SWL(psi) _____ + SWL(ft) 21.5
Existing Well / Predeepening _____
Completed Well _____
Flowing Artesian? Dry Hole?

WATER BEARING ZONES Depth water was first found 60'

SWL Date	From	To	Est Flow	SWL(psi)	+ SWL(ft)
<u>10-21-08</u>	<u>60</u>	<u>114</u>	<u>45GPM</u>		<u>21.5</u>

(11) WELL LOG Ground Elevation _____

Material	From	To
Silty sand, coarse gravel.	0	25
Sandy gravel, trace cobbles, boulders.	25	60
Sand, gravel, boulders, water bearing.	60	114
Green sandstone.	114	115
Black sandstone.	115	120

Date Started 10-14-2008 Completed 10-21-2008

(unbonded) Water Well Constructor Certification
I certify that the work I performed on the construction, deepening, alteration, or abandonment of this well is in compliance with Oregon water supply well construction standards. Materials used and information reported above are true to the best of my knowledge and belief.
License Number _____ Date _____
Password: (if filing electronically) _____
Signed _____

(bonded) Water Well Constructor Certification
I accept responsibility for the construction, deepening, alteration, or abandonment work performed on this well during the construction dates reported above. All work performed during this time is in compliance with Oregon water supply well construction standards. This report is true to the best of my knowledge and belief.
License Number 10067 Date _____
Password: (if filing electronically) _____
Signed _____
Contact Info (optional) _____

WATER SUPPLY WELL REPORT - continuation page

WELL I.D. # L 0

START CARD # 1004850

(5) BORE HOLE CONSTRUCTION

BORE HOLE			SEAL					sacks/ lbs
Dia	From	To	Material	From	To	Amt		

FILTER PACK

From	To	Material	Size

(6) CASING/LINER

Casing	Liner	Dia	+	From	To	Gauge	Stl	Plstc	Wld	Thrd
○	○						○	○		
○	○						○	○		
○	○						○	○		
○	○						○	○		
○	○						○	○		
○	○						○	○		
○	○						○	○		
○	○						○	○		
○	○						○	○		

(7) PERFORATIONS/SCREENS

Perf/S creen	Casing/ Liner	Screen Dia	From	To	Scrn/slot width	Slot length	# of slots	Tele/ pipe size

(8) WELL TESTS: Minimum testing time is 1 hour

Yield gal/min	Drawdown	Drill stem/Pump depth	Duration (hr)

Water Quality Concerns

From	To	Description	Amount	Units

(10) STATIC WATER LEVEL
Water Bearing Zones

SWL Date	From	To	Est Flow	SWL(psi)	+ SWL(ft)

(11) WELL LOG

Material	From	To

RECEIVED
DEC 15 2008
WATER RESOURCES DEPT
SALEM, OREGON

RECEIVED
JAN 26 2009
WATER RESOURCES DEPT
SALEM, OREGON

Comments/Remarks

MULT 97681

Site Analysis

SITE AREA	311,985 SF
EXISTING BUILDING AREA	511,200 SF
LANDSCAPE AREA	24,515 SF
BUILDING 1 AREA	27,515 SF
BUILDING 2 AREA	20,351 SF
LANDSCAPE AREA	122,207 SF
LANDSCAPE AREA	188,878 SF
LANDSCAPE AREA	44,028 SF
LANDSCAPE AREA	44,028 SF
LANDSCAPE AREA	4,531 SF

BUILDING 1	5,000 SF
OFFICE	1,000 SF
WAREHOUSE	7,875 SF
MANUFACTURING	7,875 SF

VEHICLE PARKING	50,000 SF
BUILDING 1	27,515 SF
BUILDING 2	20,351 SF
MANUFACTURING	7,875 SF
OFFICE	1,000 SF
LANDSCAPE AREA	122,207 SF
LANDSCAPE AREA	188,878 SF
LANDSCAPE AREA	44,028 SF
LANDSCAPE AREA	44,028 SF
LANDSCAPE AREA	4,531 SF

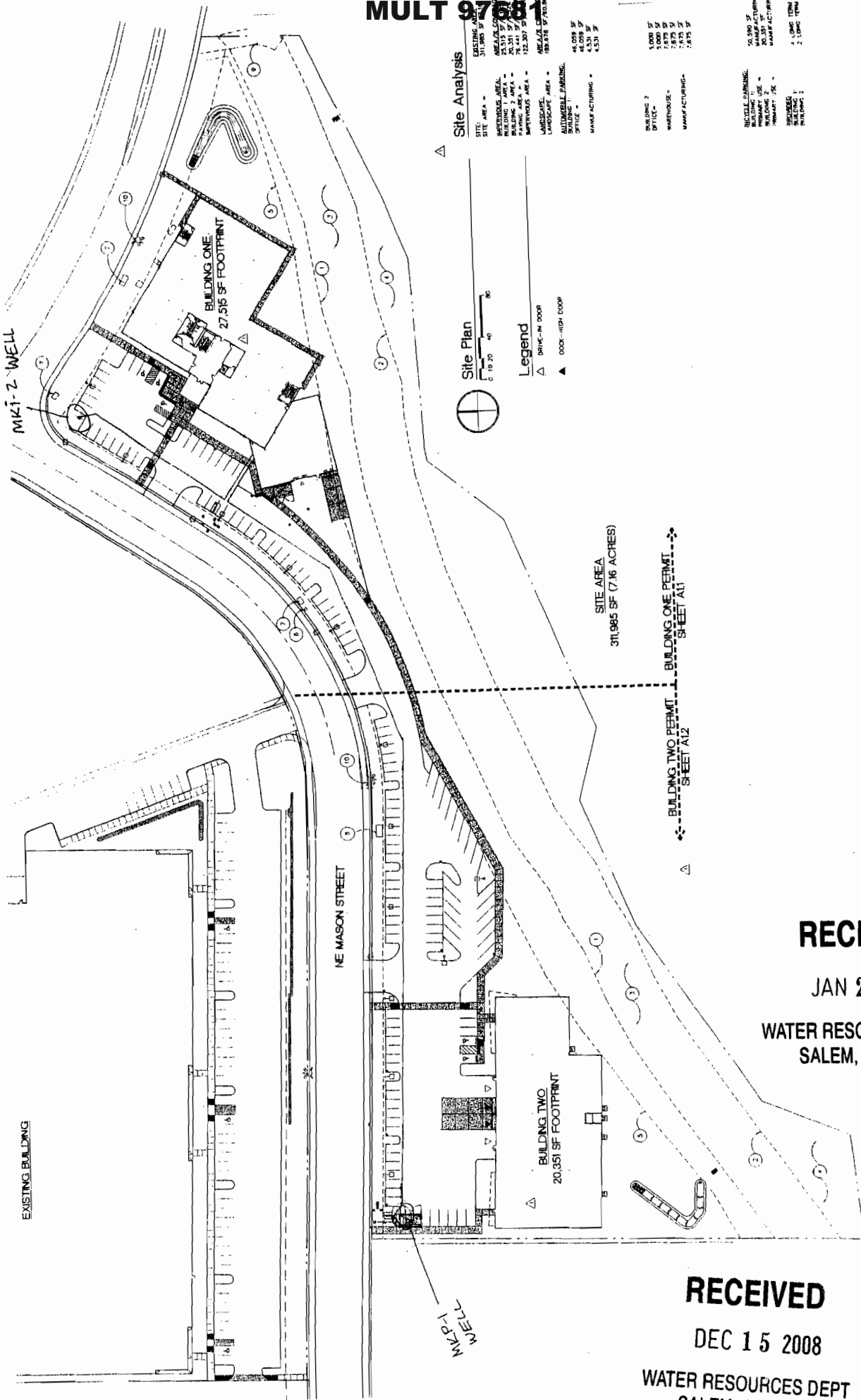

Legend

- △ DRIVE-IN DOOR
- ▲ DOOR-HIGH DOOR

SITE AREA
311,985 SF (7.16 ACRES)

BUILDING TWO PERMIT SHEET A12
BUILDING ONE PERMIT SHEET A11

RECEIVED

JAN 26 2009

WATER RESOURCES DEPT
SALEM, OREGON

RECEIVED

DEC 15 2008

WATER RESOURCES DEPT
SALEM, OREGON

R2E T18E

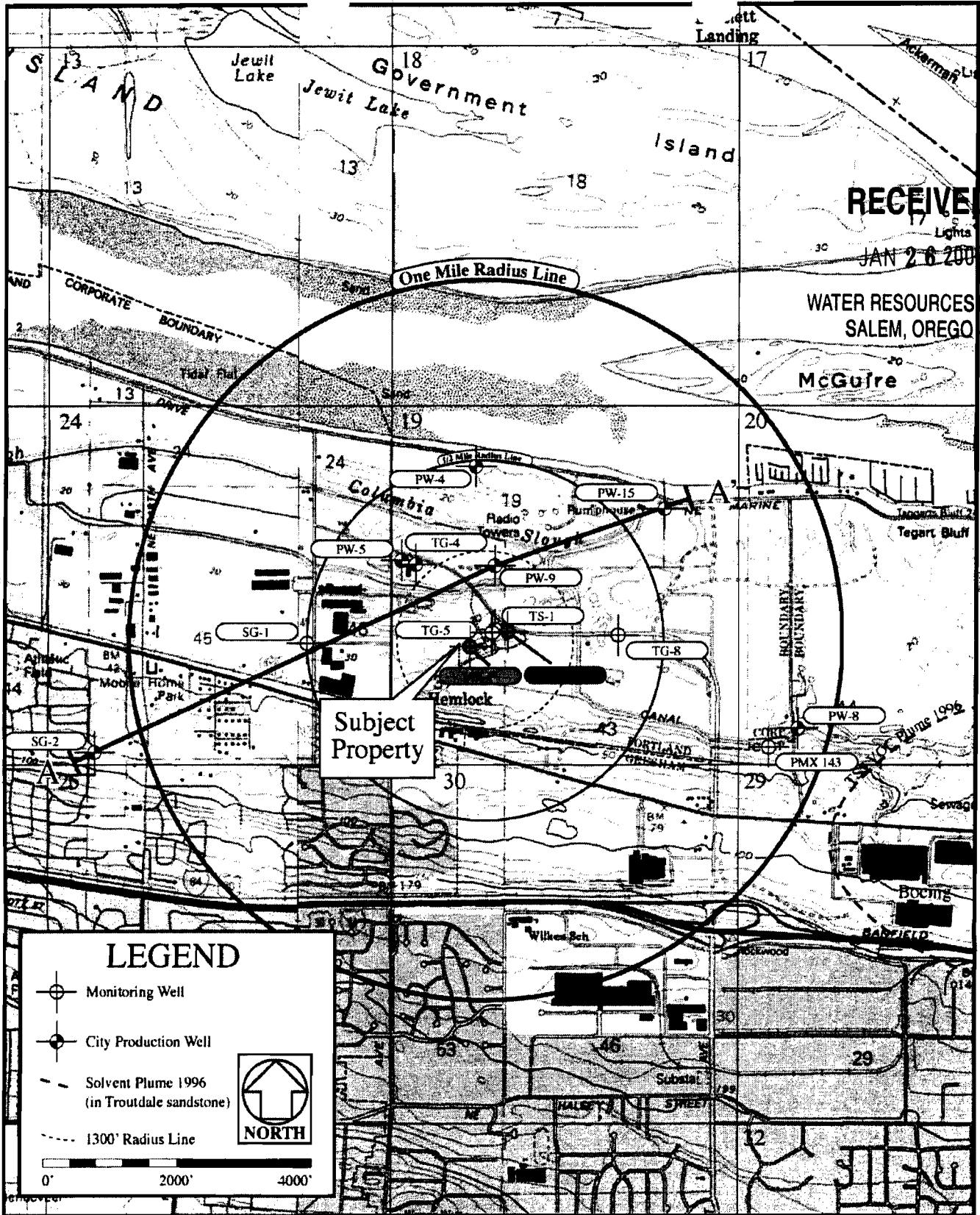

RECEIVED
JAN 26 2008

WATER RESOURCES DEPT
SALEM, OREGON

Subject Property

LEGEND

- Monitoring Well
 - City Production Well
 - Solvent Plume 1996 (in Troutdale sandstone)
 - 1300' Radius Line
- NORTH
- 0' 2000' 4000'

ROGER N. SMITH ASSOCIATES, INC.
Groundwater and Environmental Consultants

RECEIVED

DEC 15 2008

WATER RESOURCES DEPT
SALEM, OREGON

Project Manager Roger N. Smith
Drawn By Steven Dopp
Project Number 07-856.2
Date Last Modified May 22, 2008

<p>McKinstry Co. Low Temperature Geothermal Wells and nearby wells</p>
<p>Map adapted from TOPO!® ©2006 National Geographic Map Approximate Scale: 1:24 000</p>
<p>Figure 1</p>