

STATE ENGINEER
Salem, Oregon

UMAT
4606

Well Record

GR- 1414

STATE WELL NO. 6N/35-25E
COUNTY Umatilla
APPLICATION NO. GR- 1465

OWNER: Frank L. Garrett

MAILING ADDRESS: Rt. 1

LOCATION OF WELL: Owner's No.

CITY AND STATE: Wilder, Idaho

SW 1/4 NW 1/4 Sec. 25 T. 6 N. R. 35 W. W.M.

Bearing and distance from section or subdivision corner 300' W. & 26' N. from SE cor. of SW 1/4 NW 1/4 of Sec. 25

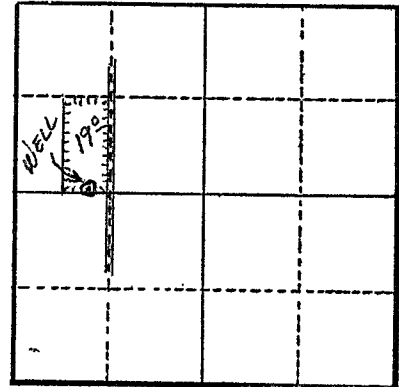

Section 25

Altitude at well 900'

TYPE OF WELL: Dug & Drilled Date Constructed 1921

Depth drilled 100' Depth cased 55'

CASING RECORD:

8" steel from 35' to 55'

FINISH:

AQUIFERS:

WATER LEVEL:

35' (March)

PUMPING EQUIPMENT: Type F. M. H.P. 5
Capacity 350 G.P.M.

WELL TESTS:

Drawdown ft. after hours G.P.M.
Drawdown ft. after hours G.P.M.

USE OF WATER Irrigation Temp. °F., 19

SOURCE OF INFORMATION GR Record

DRILLER or DIGGER Overturf

ADDITIONAL DATA:

Log N.A. Water Level Measurements Chemical Analysis Aquifer Test

REMARKS:

Irrigation of 19 acres.