

STATE ENGINEER
Salem, Oregon

UMAT
4615

Well Record

STATE WELL NO. 6N/35-25N(4)
COUNTY Umatilla
APPLICATION NO. GR 607

OWNER: Henry W. & Ruby M. Shakelford

MAILING ADDRESS: Rt 3

LOCATION OF WELL: Owner's No. #2

CITY AND STATE: Milton-Freewater

SW 1/4 SW 1/4 Sec. 25 T. 6 N. R. 35 E., W.M.

Bearing and distance from section or subdivision corner A point 100 ft. W from a point 690 ft. N. of S.E. cor. of S.W. 1/4 of S.W. 1/4

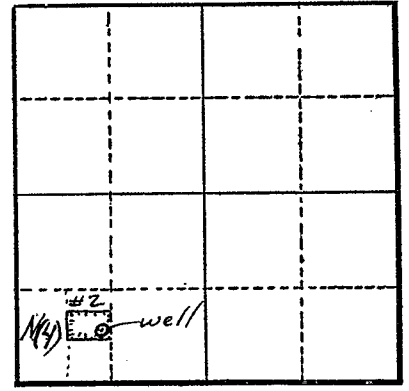

Altitude at well 900

TYPE OF WELL: Dug Drilled Date Constructed 1916

Depth drilled 60 Depth cased

Section 25

CASING RECORD:

Dug 40 ft.
8" Casing FROM 40' to 46'

FINISH:

AQUIFERS:

WATER LEVEL:

15 ft.

PUMPING EQUIPMENT: Type Centrifugal H.P. 2
Capacity 225 G.P.M.

WELL TESTS:

Drawdown ft. after hours G.P.M.
Drawdown ft. after hours G.P.M.

USE OF WATER irrigation - 4 ac. Temp. °F., 19.....

SOURCE OF INFORMATION GR 607

DRILLER or DIGGER

ADDITIONAL DATA:
Log Water Level Measurements Chemical Analysis Aquifer Test

REMARKS: