



umat 55440

**From: Notes in Ground Water Application File**

Application No. G-5133

Permit No. 5150

**Helix Well 2:**

Well #2 in City Park.

Well was dug in 1889. Then in 1918. Well was tunneled approx. 150 ft N.E. of well site for more water. Water was not hit at the N.E. tunnel. Then in the same year 1918, another tunnel was dug S.W. of well site approx. 100 ft. from well site. Tile was laid in these tunnels. Clay tile with Gravel around and between pipe in case of tunnel caving in. Tunnels were dug at 52 ft 10 in levels. Well 52 ft 10 in deep. Well was 6 ft. wide at top of ground.

June 1962

A 14 in well casing was put in well and perforated for 15 ft. from bottom of well. River run rock then dumped in well around casing 27 ft. up casing. Then 12 in of concrete on top of rock. Then filled with clay and dirt to ground level. One 6 in pipe run through cement so could add more rock if necessary and also 2 in pipe approx. 6 ft long run into casing to add chlorine if ever need be. Well pumps 200 Gal min.

WEHL # 2 in City Park.

Application No. G 5133

Permit No.

well was dug in 1889. Then in 1918 well was tunneled approx. 150 ft. N.E. of well site for more water. water was not hit at the N.E. tunnel. Then in the same year 1918, another tunnel was dug S.W. of well site approx. 100 ft. from well site. Till was laid in these tunnels Clay tile with gravel around + between pipe In case of tunnel caving in. Tunnels were dug at 52 ft. 10 in. levels. Well 52 ft. 10 in deep. well was left wide at top of ground.

June 1962

a 1 1/2 in well casing was put in well and perforated for 15 ft. from Bottom of well.

River run Rock then dumped in well around casing 27 ft. up casing. Then 12 in of concrete on top of rock. Then filled with Clay and dirt to ground level. one 6 in pipe run through cement so could more rock if necessary

2 Cont. Well # 2.

Pipe

and also 2 in Pipe approx. 6 ft. long run in to casing to add Chlorine if ever need be. Well pumps 200 Gal min.

TURBINE PUMP

Application No. G 5133  
Permit No. G 5150

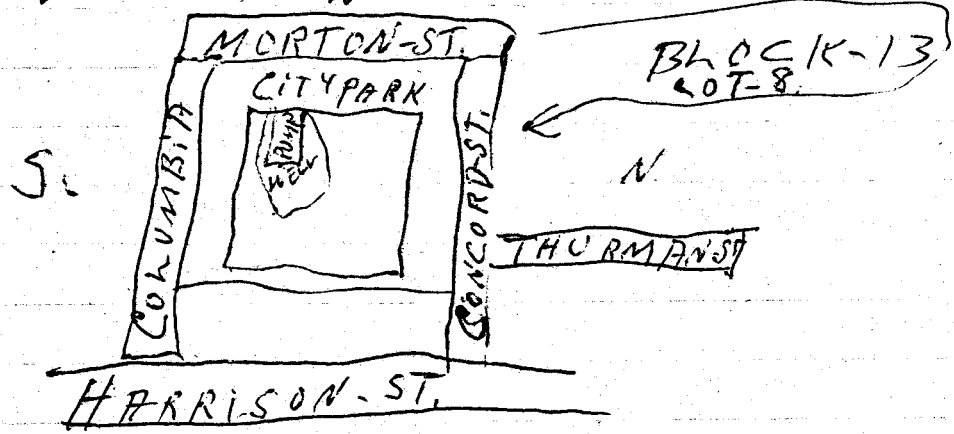
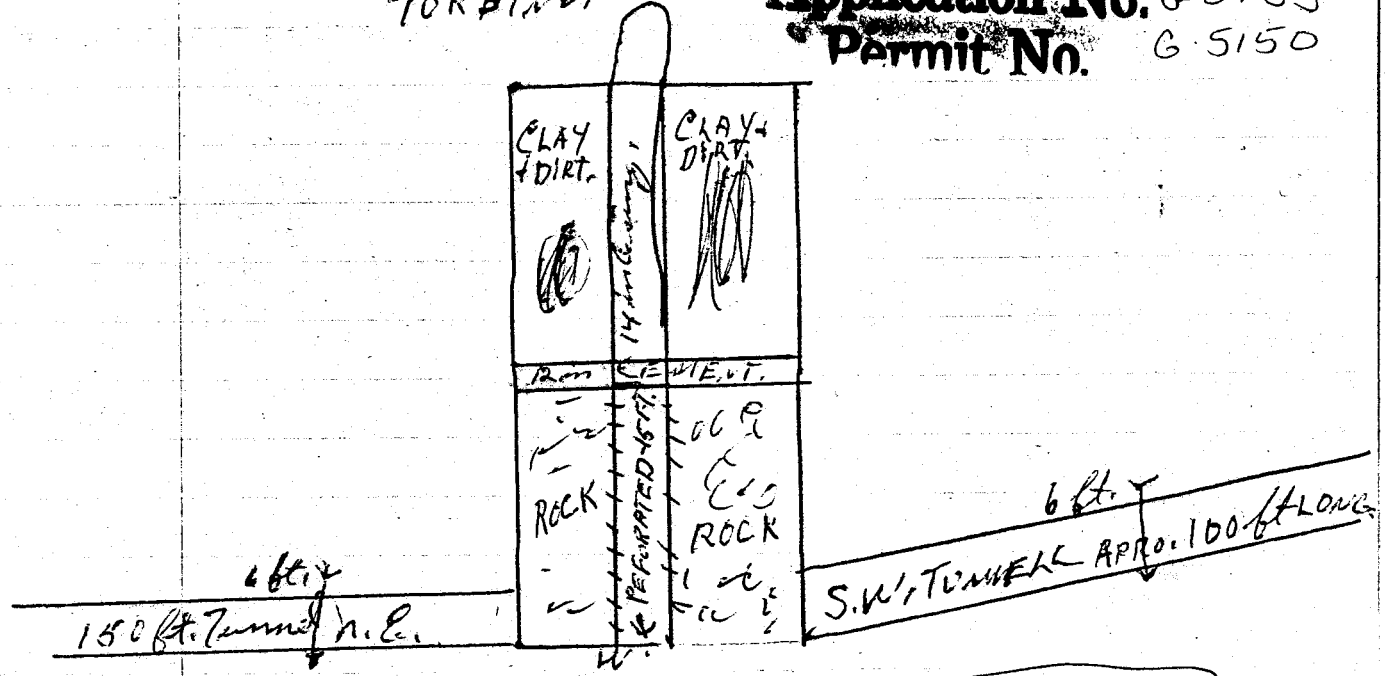

E.