

WASH  
5110

# Well Record

OWNER: *Dan Hebeisen*

MAILING ADDRESS: *Rt 1, Box 161-C*

LOCATION OF WELL: Owner's No. *1*

CITY AND STATE: *Hillsboro, Oregon*

*NE SE*  
~~SW~~ *SW* 1/4 *3* Sec. *3* T. *1* N. *1*, R. *2* W., W.M.

Bearing and distance from section or subdivision corner *210 feet south and 6.6 feet west at 1/4 on east side of section 3.*

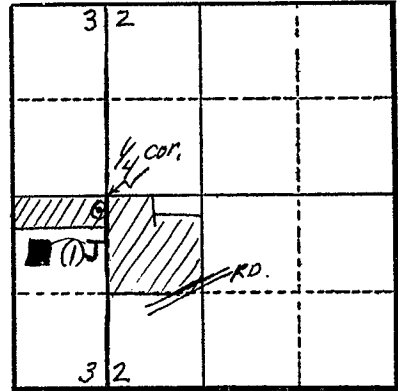

Section *2*

Altitude at well *360 feet Interpolated*

TYPE OF WELL: *Drilled* Date Constructed *Feb. 11, 1952*

Depth drilled *542'* Depth cased

### CASING RECORD:

*6 inch steel casing set from 0 to 175 feet.*

### FINISH:

*unknown*

### AQUIFERS:

*basalt from 175 to 543 feet.*

### WATER LEVEL:

*110 feet below land surface.*

PUMPING EQUIPMENT: Type *Byron Jackson* H.P. *15*  
Capacity *100* G.P.M.

### WELL TESTS:

Drawdown *214* ft. after *70* hours *pumping* G.P.M.  
Drawdown *282* ft. after *80* hours " G.P.M.

USE OF WATER *Irrigation 48.7 acres* Temp. °F. *19*

SOURCE OF INFORMATION *Registration Statement GR-331*

DRILLER or DIGGER

### ADDITIONAL DATA:

Log *No.* Water Level Measurements Chemical Analysis Aquifer Test

### REMARKS:

*basalt - from 175 to 543 feet - 368 feet thick*