

YAMH 55661

State of Oregon
WATER WELL REPORT (as required by ORS 537.765)

Page 1 of 1

State Well ID L100573
 Start Card # 1010438

(1) **OWNER:** Well No. 2685
 Name **NORTH AMERICAN PLANTS LLC**
 Address **POB 743**
 City **LAFAYETTE** St OR Zip 97127

(2) **TYPE OF WORK:** NEW WELL

(3) **DRILL METHOD:** CABLE

(4) **PROPOSED USE:** IRRIGATION

(5) **BORE HOLE CONSTRUCTION:**
 Special Construction Approval NO _____ Depth of Compl. Well 159 ft
 Explosives used NO _____ Type _____ Amount _____

BORE		SEAL		Amount	
Diam.	From To	Material	From To		
12	0 104	BENTONITE CHIP	0 48	45	SAX
6	104 159				

Seal placement method **POURED/HYDRATED**
 Backfill: from _____ ft to _____ ft Material _____
 Gravel: from 48 ft to 104 ft Size 3/8" PEA

(6) **CASING/LINER:**

	Diam.	From	To	Gauge	Material	Connection
Casing	6	+1	88	.25	STEEL	WELDED
	6	100	104	.25	STEEL	WELDED

Liner 4 59 159 SCH40 PLASTIC THREADED

Final Location of shoe(s) **NO SHOE, SPLINE-LOC LINER**

(7) **PERFORATIONS/SCREENS:**
 Perf. Method **CIRCULAR SAW**
 Screens Type **CONF. V-WIRE** Material **STAINLESS STEEL**

From	To	Slot Size	Number	Diam.	Tele/pipe Size	Casing/liner
88	100	70		6" PS		CASING
81	140	.1X6"	60			LINER
150	158	.1X6"	14			LINER

(8) **WELL TESTS:** Minimum testing time is 1 hour
 Test type **AIR**

Yield GPM	Draw-down	Drill stem at	Time
12	138	159	1 hr.
12	130	151	1

Temperature of water 54F Depth Artesian Flow Found _____
 Was water analysis done? YES By whom **BLUE H2O**
 Reason for water not suitable for use _____
 Depth of strata _____

(9) **LOCATION OF WELL** by legal description:
 County **YAMHILL** Lat. ' ' ' Long. ' ' '
 Township 4 S Range 4 W WBL.
 Section 11 NW 1/4 SE 1/4
 Tax Lot 5400 Lot Block Subdivision
 Street Address of Well (or nearest Address)
 3367 ST JOSEPH RD MCHINNIVILLE, OR

(10) **STATIC WATER LEVEL:**
 21 ft. below land surface. Date 07/07/10
 Artesian pressure _____ lb per square in. Date _____

(11) **WATER BEARING ZONES:**
 Depth at which water was first found 21

From	To	Est Flow Rate	SNL
21	154	12	21
_____	_____	_____	_____
_____	_____	_____	_____

(12) **WELL LOG:**

Material	Ground elevation		SNL
	From	To	
TOP SOIL	0	6	
CLAY, BROWN	6	25	
CLAY, BLUE/GRAY	25	58	
CLAY, GREEN W/CLAYSTONE BITS W/SOME SAND	58	68	
CLAY, GRAY W/CLAYSTONE/SANDSTONE			
STRATS, HARD/SOFT	68	83	
SAND W/A FEW FINE HARD PARTICLES	83	95	
CLAY, BLUE/GRAY W/HARD PARTICLES	95	100	
CLAY, GRAY W/CLAYSTONE	100	104	
COMPACTED SANDY CLAYSTONE/CLAY GRAY	104	121	
COMPACTED SANDY "/CLAY GRAY AND BROWN	121	154	
CLAYSTONE, GRAY W/GRAY CLAY	154	159	

DAVE PAYSINGER, BLUE WATER DRILLING CO.
 (503) 868 7878

Date started 06/29/10 Completed 07/07/10

(unbonded) Water Well Constructor Certification: I certify that the work I performed on the construction, alteration, or abandonment of this well is in compliance with Oregon water supply well construction standards. Materials used and information reported above are true to my best knowledge and belief.

Signed _____ WWC Number _____
 Date _____

(bonded) Water Well Constructor Certification: I accept responsibility for the construction, alteration, or abandonment work performed on this well during the construction dates reported above. All work performed during this time is in compliance with Oregon water supply well construction standards. This report is true to the best of my knowledge and belief.

Signed *David L. Paysinger* WWC Number 1438
 Date 07/08/10

RECEIVED

JUL 14 2010

WATER RESOURCES D
 SALEM, OREGON

St Joseph RD

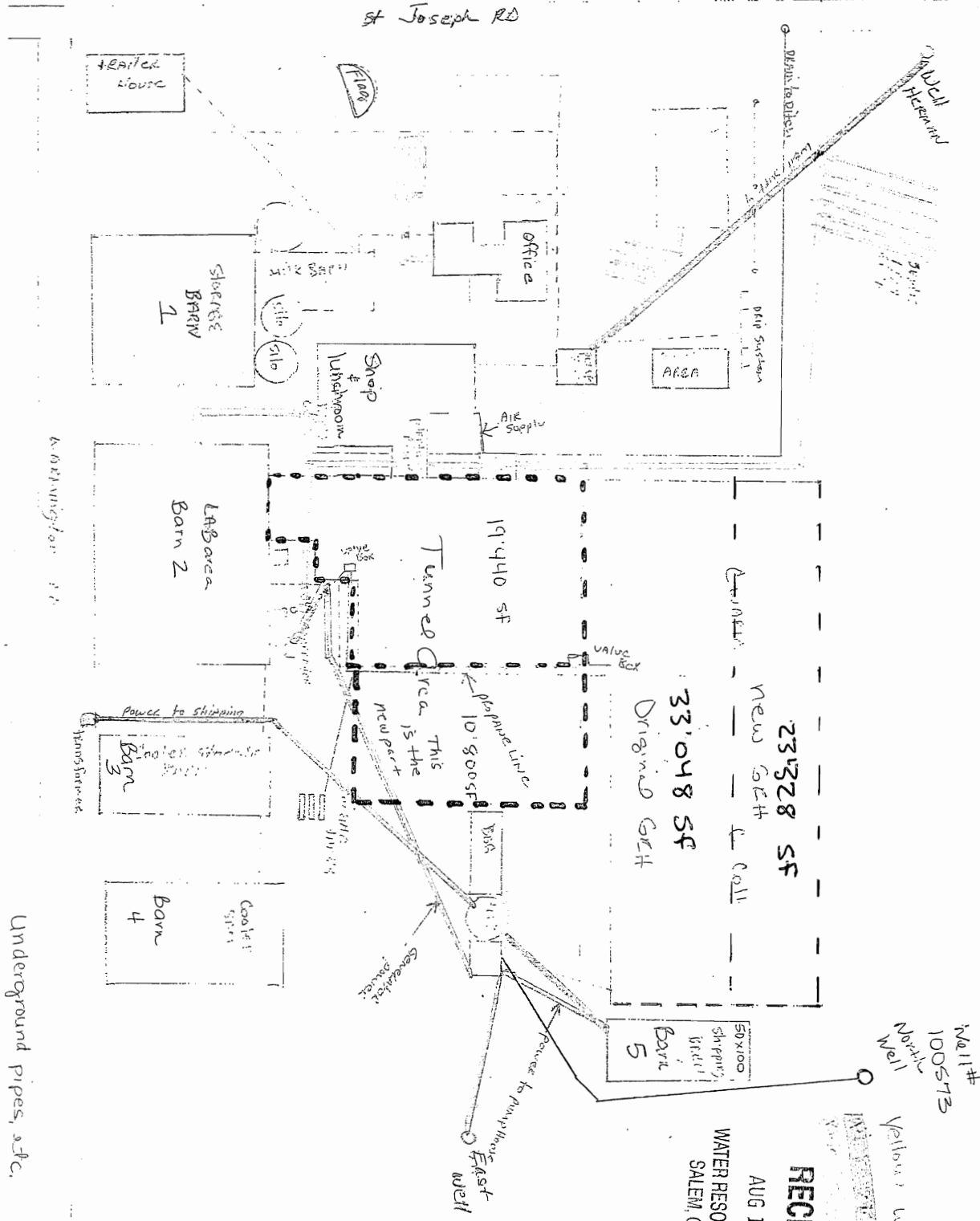

RECEIVED
 AUG 18 2010
 WATER RESOURCES DEPT
 SALEM, OREGON

LAND OWNER SUBMITTED MAP